

# Surface water drainage strategies and SuDS

## Helping you meet the planning authority requirements for surface water management

Ambiental's surface water drainage strategies show how surface water affects a site and the surrounding area.

Specifically designed to comply with the National Planning Policy Framework (NPPF) and Environmental Agency guidance, our drainage strategies ensure developers can show that surface water drainage has been considered as part of a development. This is especially important in areas at risk of flooding, either from rivers or the sea, or in council-defined Critical Drainage Areas.

As experts in flooding and water modelling we can provide guidance on what you need, and our drainage strategies can include:

- Advice on developing a sustainable urban drainage system (SuDS)
- Initial design parameters for drainage components, such as soakaways, ponds, etc.
- Technical assistance to understand surface water flooding including surface water modelling through our own UKFloodMap4™ - the most complete and up-to-date flood data set currently available
- Bespoke detailed site surface water modelling

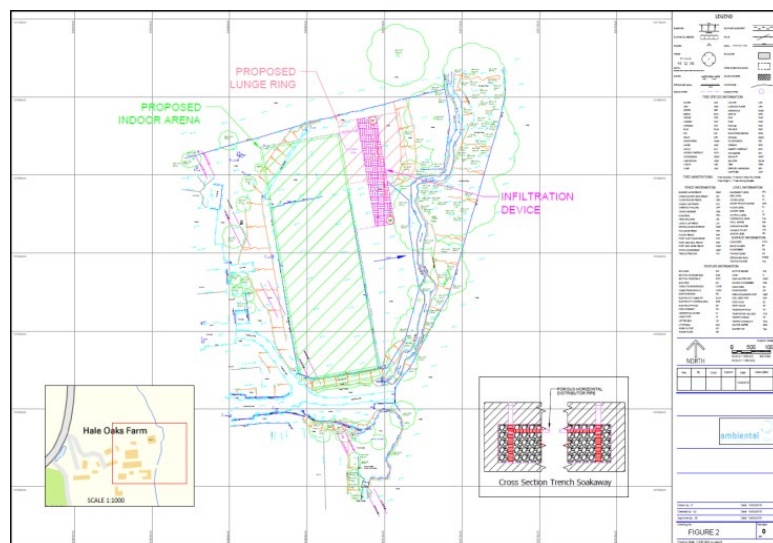

All of our strategies include visualisations of the recommendations outlined for your site. We will incorporate the drainage strategy recommendations into your plans to allow you to see how it will interact with your site.

### KEY BENEFITS

- ✓ Greatly improves chances of achieving planning consent
- ✓ Cost effective, especially when undertaken at an early stage
- ✓ Reduces the risk of flooding to the development and the surrounding area
- ✓ Can improve local amenities and increase bio-diversity, further supporting your planning application
- ✓ Can identify development constraints when undertaken at the feasibility stage

### OUR STRATEGIES - AT A GLANCE

- Comply with the NPPF, Environment Agency guidance and local planning policy
- Determine how surface water runoff will be managed
- Outline recommendations for Sustainable urban Drainage Systems (SuDS)
- Can be produced as an independent report or combined with a Flood Risk Assessment or Detailed Drainage Design
- Suitable for all sizes and types of developments

# Our Process

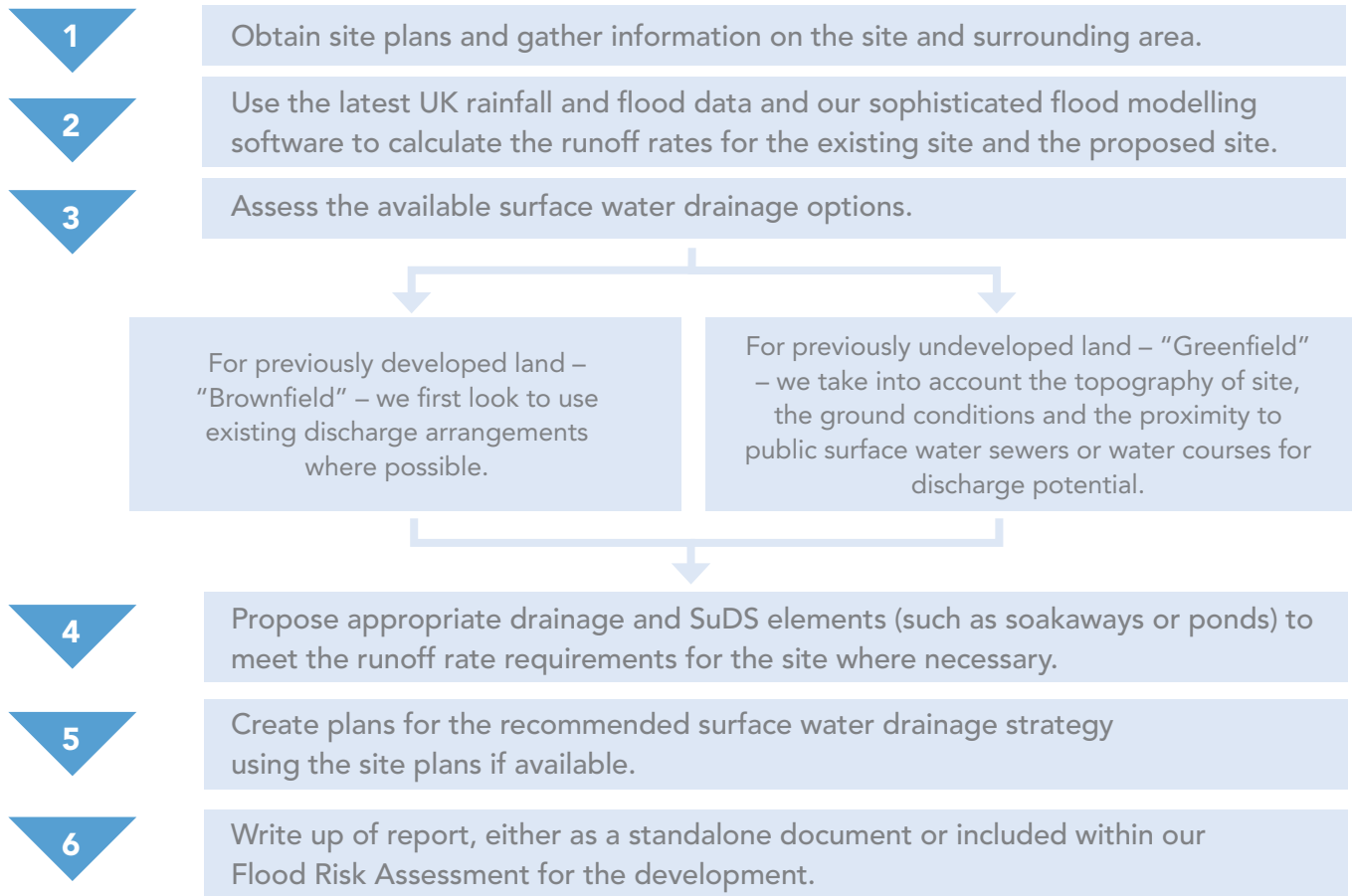

## FAQ's

### Who needs a surface water drainage strategy?

Developers building new structures or increasing the built footprint on a site are some of the most likely to need a surface water drainage strategy. As of April 2015 any development of 10+ units (including residential, industrial, commercial and mixed use sites) is required by law to look into the potential use of Sustainable urban Drainage Systems, often as part of a drainage strategy.

A development's location within the EA's Flood Zones 2 and 3, or within an area identified as having a surface water flooding problem are also likely to need a drainage strategy. Even, if your development doesn't meet these criteria, Local Planning Authorities have the final say as to who needs a strategy. It's best to speak to your local planning office before you submit a planning application.

### Is this the only surface water drainage report I need?

This very much depends on the location, size and type of your development, as well as the views of the EA and your local planning authority. There is a second-stage report known as a 'Detailed Drainage Design'.

A Detailed Drainage Design provides comprehensive layouts, long-sections, construction details (such as type of pipes, manhole locations, etc.) to adoptable standards. Potentially, on-site soil testing may be required. Not all planning applications that need a Drainage Strategy will need a Detailed Drainage Design (or it may be a condition of planning approval). Our experts will always be on hand to discuss and advise throughout your planning process.

## Contact Us

If you would like a quote or to discuss your requirements further please contact:

**0203 857 8540** [drainage@ambiental.co.uk](mailto:drainage@ambiental.co.uk)

**ambiental**<sup>®</sup>  
predicting · preventing · protecting

[info@ambiental.co.uk](mailto:info@ambiental.co.uk)

**UK Head Office**

The Sussex Innovation Centre, Science Park Square, Brighton, BN1 9SB, UK

© Ambiental Technical Solutions Ltd 2016

[www.ambiental.co.uk](http://www.ambiental.co.uk)

**+44 (0)203 857 8530**